



## Disinfection fluid Monitor Series

### Online Dissolved Ozone Meter T4058

#### Function

Online dissolved ozone meter is a microprocessor-based water quality online monitoring control instrument.

#### Typical Use

This instrument is widely used in online monitoring of water supply, tap water, rural drinking water, circulating water, washing film water, disinfectant water, pool water. It continuous monitoring and control water quality disinfection (ozone generator matching) and other industrial processes.

#### Mains Supply

85~265VAC±10%,50±1Hz, power ≤3W;  
9~36VDC, power consumption≤3W;

#### Measuring Range

Dissolved Ozone: 0~20ppm; 0~20mg/L;  
Temperature: 0~150℃.

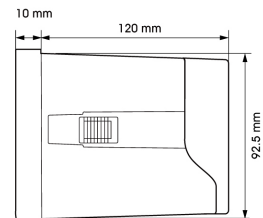
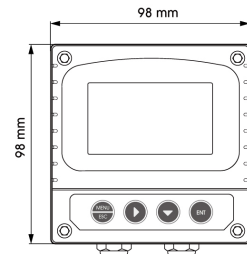

## Online Dissolved Ozone Meter T4058

### Features

1. Large display, standard 485 communication, with online and offline alarm, 98\*98\*120mm meter size, 92.5\*92.5mm hole size, 3.0 inch large screen display.
2. The data curve recording function is installed, the machine replaces the manual meter reading, and the query range is arbitrarily specified, so that the data is no longer lost.
3. Built-in various measurement functions, one machine with multiple functions, meeting the requirements of various measurement standards.
4. The design of the whole machine is waterproof and dustproof, and the back cover of the connection terminal is added to extend the service life in harsh environments.
5. Panel/wall/pipe installation, three options are available to meet various industrial site installation requirements.



Measurement Mode



Calibration Mode

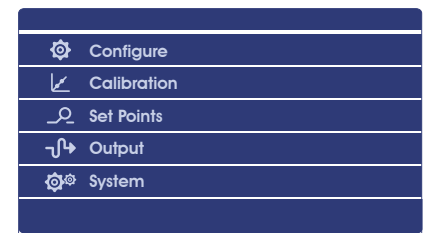

Setting mode

## Electrical connections

Electrical connection The connection between the instrument and the sensor: the power supply, output signal, relay alarm contact and the connection between the sensor and the instrument are all inside the instrument. The length of the lead wire for the fixed electrode is usually 5-10 meters, and the corresponding label or color on the sensor Insert the wire into the corresponding terminal inside the instrument and tighten it.

## Instrument installation method

### Embedded installation

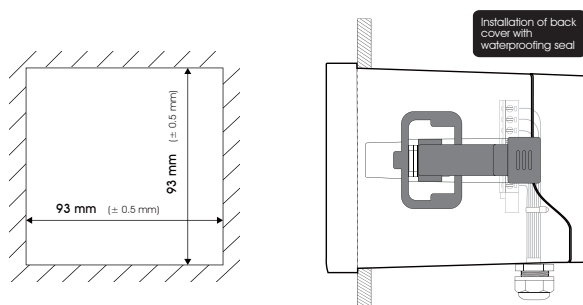

Embedded mounting Cut-out size

Embedded the instrument into the square hole, and fix it with the provided clasp.

### Wall mounted installation

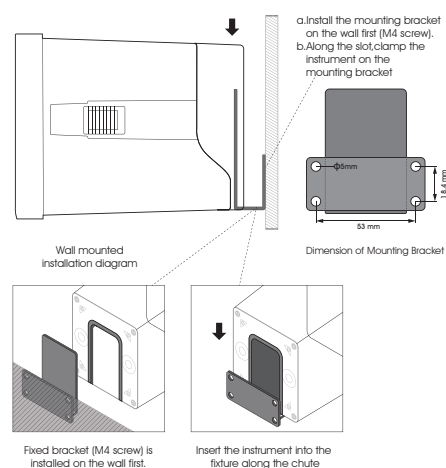

## Technical specifications

Measurement range	0.005~20mg/L;0.005~20.00ppm
Measurement theory	Potentiometric method
Resolution	0.001mg/L;0.001ppm
Basic error	±1%F.S
Temperature	0~50.0°C
Temperature resolution	0.1°C
Temperature accuracy	±0.3°C
Temperature compensation	0~60.0°C
Temperature compensation	Manual or automatic
Electrode residual signal	<1‰
Response time	25°C < 60S; 35°C < 30S (To attain 90%)
Stability	At constant pressure and temperature, the weekly drift < 2%F•S;
Current output	Two: 4~20mA, 20~4mA, 0~20mA (load resistance < 750Ω)
Communication output	RS485 MODBUS RTU
Relay control set-points	Two: 3A 250VAC, 3A 30VDC
Optional power supply	85~265VAC, 9~36VDC, power consumption ≤ 3W
Working conditions	No strong magnetic field interference except the geomagnetic field.
Working temperature	-10~60°C
Relative humidity	≤ 90%
Waterproof rating	IP65
Weight	0.6kg
Dimensions	98×98×120mm
Installation opening size	92.5×92.5mm
Installation methods	Panel, wall mounting or pipeline

## CS6530 Dissolved Ozone Sensor



<b>Model No.</b>	<b>CS6530</b>
<b>Measurement method</b>	Tri-electrode method
<b>Measure material</b>	Double liquid junction,annular liquid junction
<b>Housing material/Dimensions</b>	PP, Glass, 120mm*Φ 12.7mm
<b>Waterproof grade</b>	IP68
<b>Measurement range</b>	0 - 5.000 mg/L, 0 - 20.00 mg/L
<b>Accuracy</b>	±0.05mg/L;
<b>Pressure resistance</b>	≤0.3Mpa
<b>Temperature compensation</b>	None or Customize NTC10K
<b>Temperature range</b>	0-50℃
<b>Calibration</b>	Sample calibration
<b>Connection methods</b>	4 core cable
<b>Cable length</b>	Standard 5m cable, can be extended to 100m
<b>Installation thread</b>	PG13.5
<b>Application</b>	Tap water, disinfectant fluid, etc.